



# GREEN LINE EXTENSION PROJECT



**massDOT**  
Massachusetts Department of Transportation



April 27, 2016  
Public Meeting

# Key Upcoming Dates

- GLX Presentation to the Boston Region Metropolitan Planning Organization - **4/28/16**
- Vote of the Boston Region Metropolitan Planning Organization - **5/5/16**
- MassDOT Board and MBTA Fiscal & Management Control Board Meeting - **5/9/16**
  - Presentation of final report of Interim Project Management Team



# New Community Path Concept

---

## Friends of the Community Path Proposed Concept and Estimate

- Submitted to GLX team 4/13/16
- We thank those involved for their hard work and suggestions
- Met with Conservation Law Foundation and Friends 4/15/16 to go over the details of the submitted concept

# Stations Redesign Update

## Proposed Functionality

- Open-air stations
- 4-car platform at Lechmere, all others 3-car platforms
- ADA Compliant
- Fare arrays removed
- Bike storage retained at all stations



# Example: Union Square Redesign

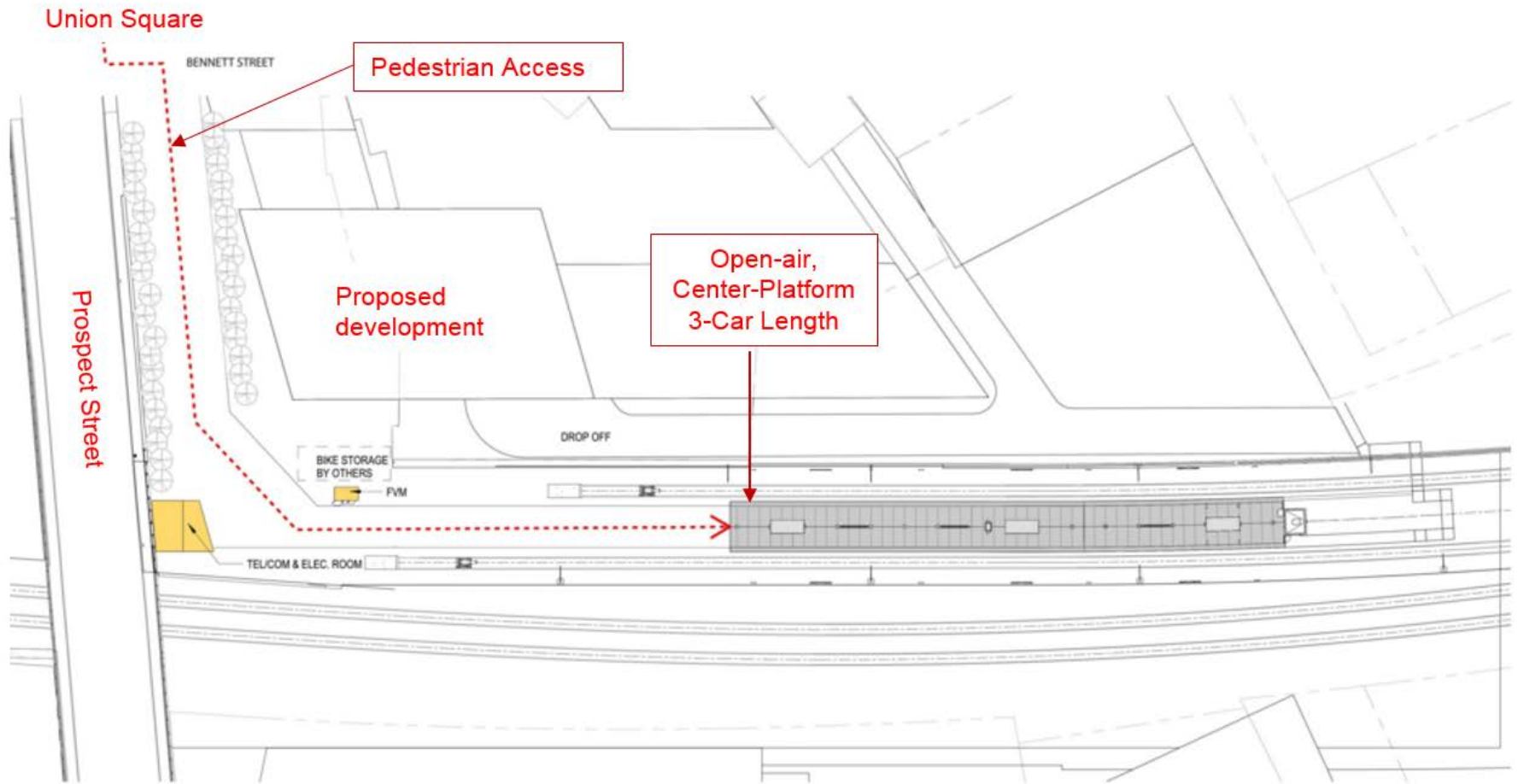

# Example: Lechmere Station Redesign

## Proposed Redesign Station Elements

- Open-air station
- North headhouse
  - 2 elevators, one stair
  - Stairs are covered but not enclosed
- Maintained 4-car platform
- Maintained bike storage
- Working with MBTA Operations on eliminating bus loop
  - Potential change reflects Lechmere no longer a hub



# Lechmere Station Redesign

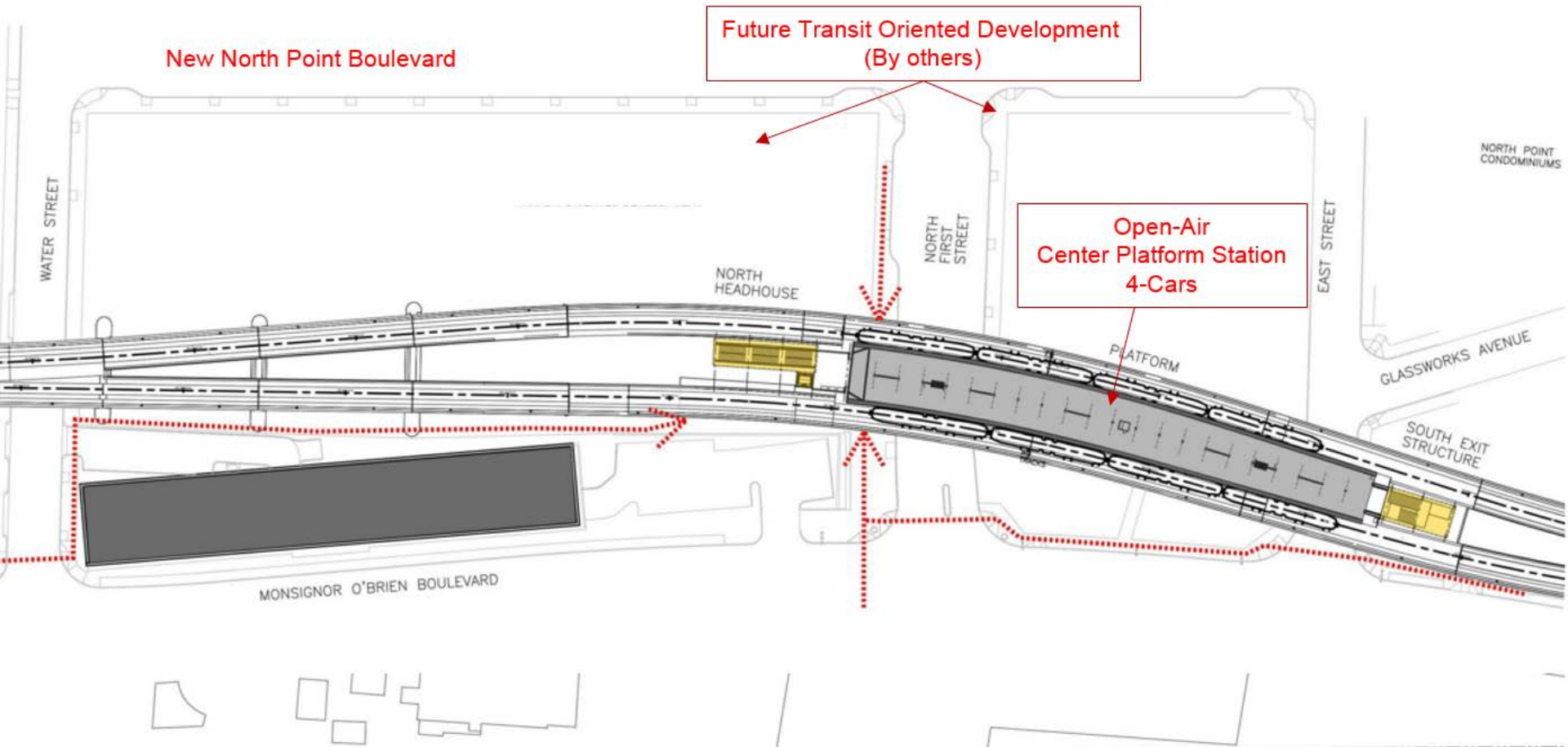

# Lechmere Station Redesign

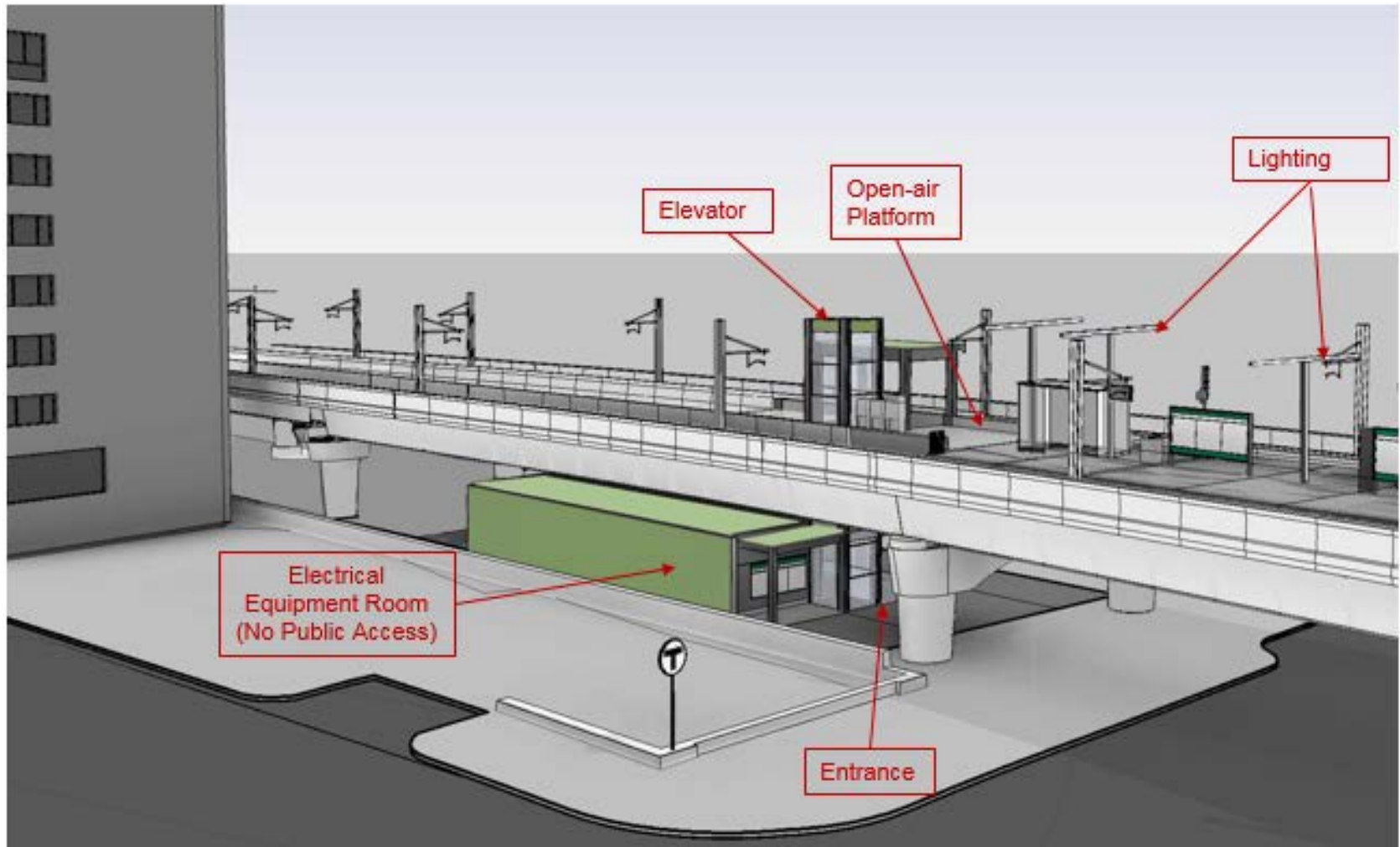



# Automatic Fare Collection Impact on GLX

---

## Reduces Station Design and Construction Cost

- Reduces the need for major structural elements
- Reduces bottom-line cost and budget
- Maintains dwell-times of off-board payment



# Commuter Rail Coordination Options

## Analyzing how limitations of operations would result in construction efficiencies

- Actions would improve budget and schedule
- If GLX is approved, details and language will be coordinated with MBTA Rail Road Operations during next phase of project.

# Commuter Rail Coordination Options

## Weekend and summer shut-downs to improve productivity, cost, and schedule

- Use of single track during the day plus weekends
- Mid-day shutdown of commuter rail (between peaks)
- Possible use of contractor supplied flaggers
- Piggyback weekends during installation of Positive Train Control (PTC)





# GREEN LINE EXTENSION PROJECT



**massDOT**  
Massachusetts Department of Transportation



April 27, 2016  
Public Meeting