



Green Line Extension Project

General Information Meeting

March 9, 2009

Brooks School

Medford, MA

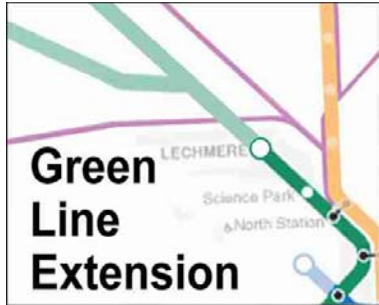

Green Line Extension Project



Agenda

- Project Goals
- The Environmental Process
- Recommended Alternative and Stations
- Status and Schedule
- Questions and Discussion

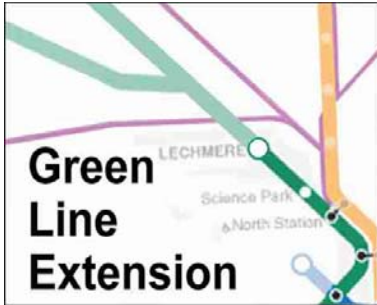

Project Goals



- Provide transit to previously under-served communities
- Improve regional air quality
- Reduce traffic congestion in project corridor
- Provide opportunities for job creation and development

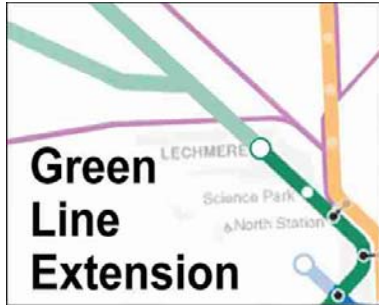

Background



- Green Line extension studied for 40 years
- 2005 Beyond Lechmere study outlined a transit investment strategy
- Expanded Environmental Notification Form submitted in 10/06 and approved after 8 week comment period
- This phase: refine alternatives and propose a recommended alternative

Green Line Extension

Project Implementation

Green Line Extension

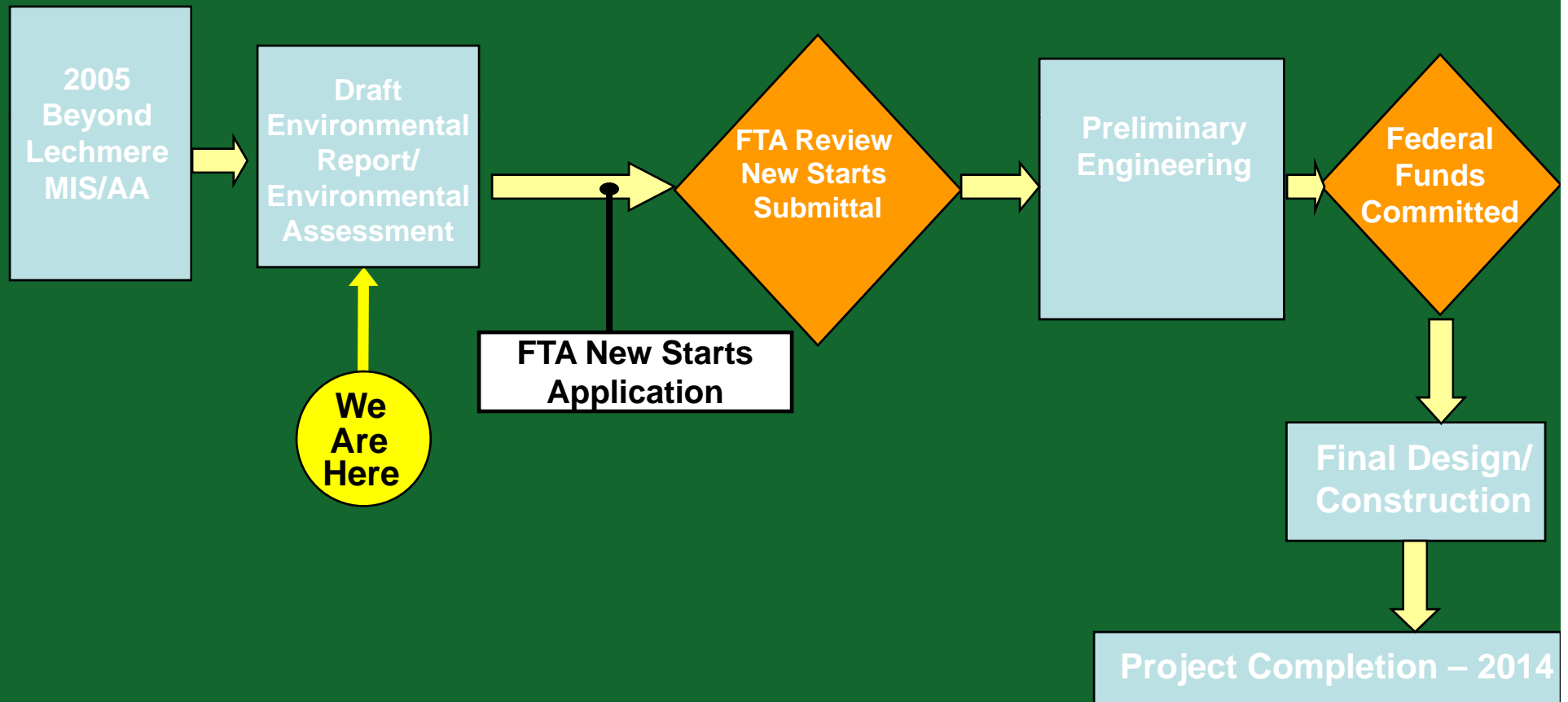

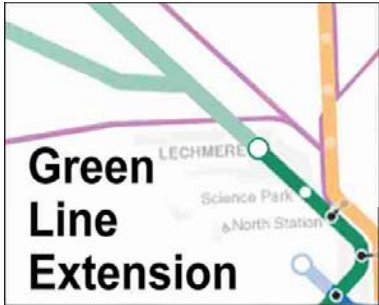

Alternatives Studied



- **Medford Hillside Branch:**
 - Extension to Medford Hillside
 - Extension to Mystic Valley Parkway/Route 16
- **Union Square Branch:**
 - via MBTA Fitchburg Line
 - via McGrath Hwy/ Somerville Ave

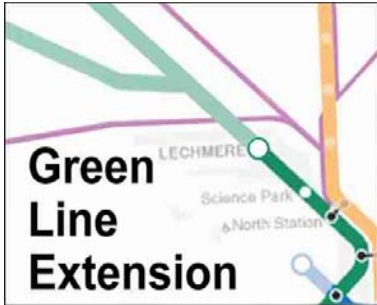

Environmental Analysis

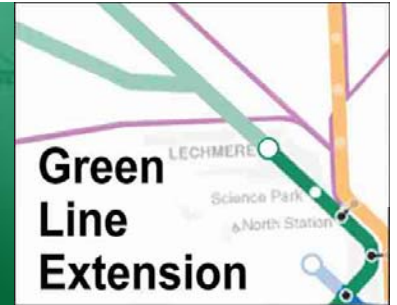

- Green Line Operations
- Community Impacts
- Noise & Vibration
- Air Quality
- Land Takings
- Traffic and Parking
- Support Facility
- Construction Impacts



Green Line Extension

Preferred Alternative

Green Line Extension



Green
Line
Extension

Typical Cross-Section

Green
Line
Extension

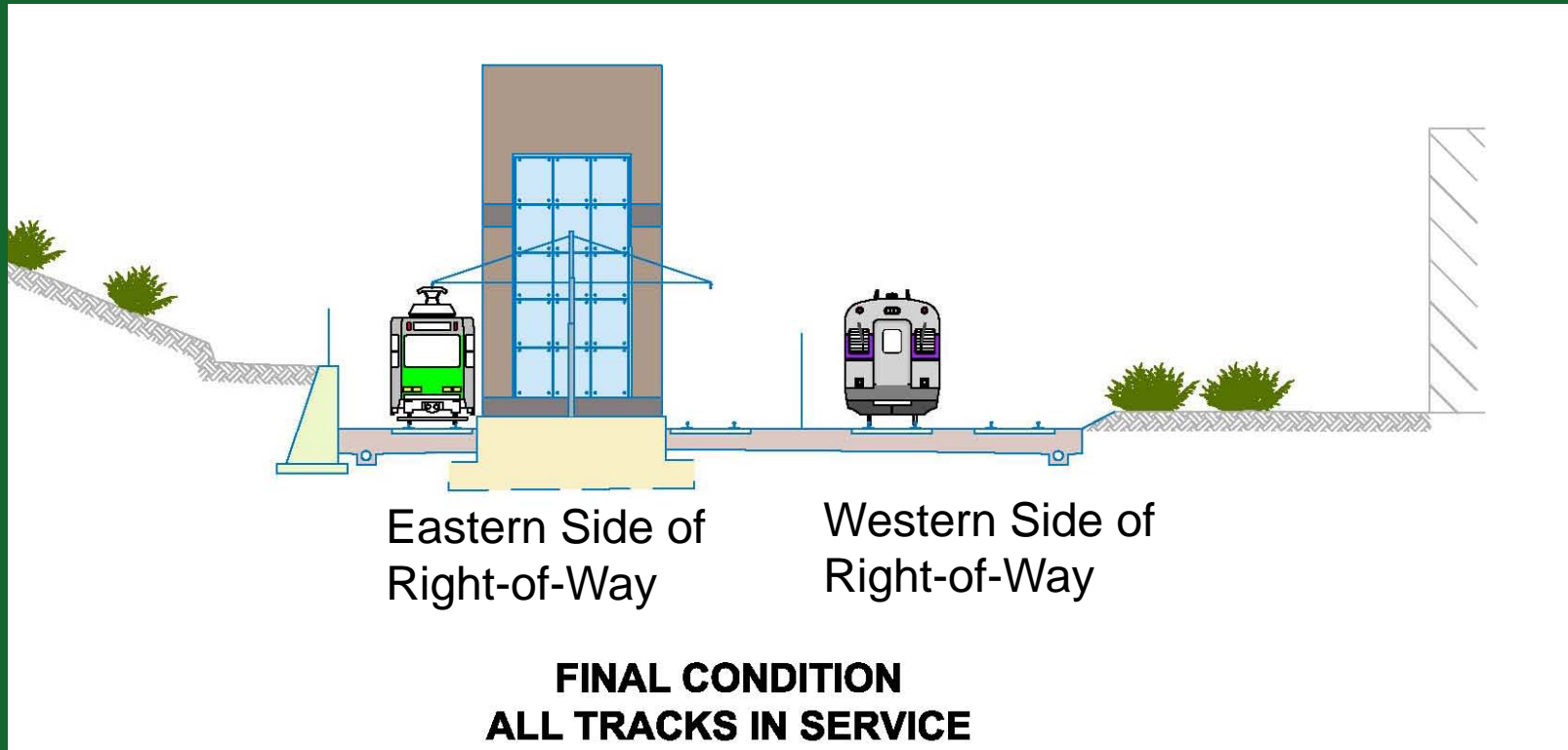

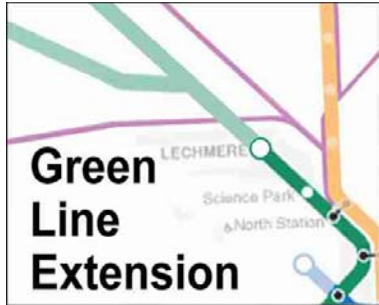

Preferred Alternative Benefits



- Operates in existing rail right-of-way, reducing property takings and construction impacts
- Attracts strong ridership, serving a variety of neighborhoods and communities
- Provides universal access, meets ADA standards
- Connects EJ residents to jobs & services
- Improves regional air quality and reduces regional vehicle miles traveled



Station Locations

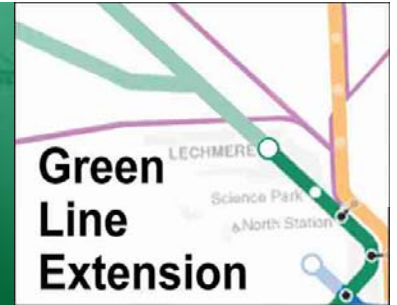

- Lechmere
- Brickbottom
- Gilman Square
- Lowell Street
- Ball Square
- College Avenue
- Mystic Valley Parkway/Route 16
- Union Square





Green
Line
Extension

Typical Station Design



Green
Line
Extension

- ADA compliant (elevators, escalators, etc.)
- Pedestrian, bicycle and auto drop-off access
- Transit connections

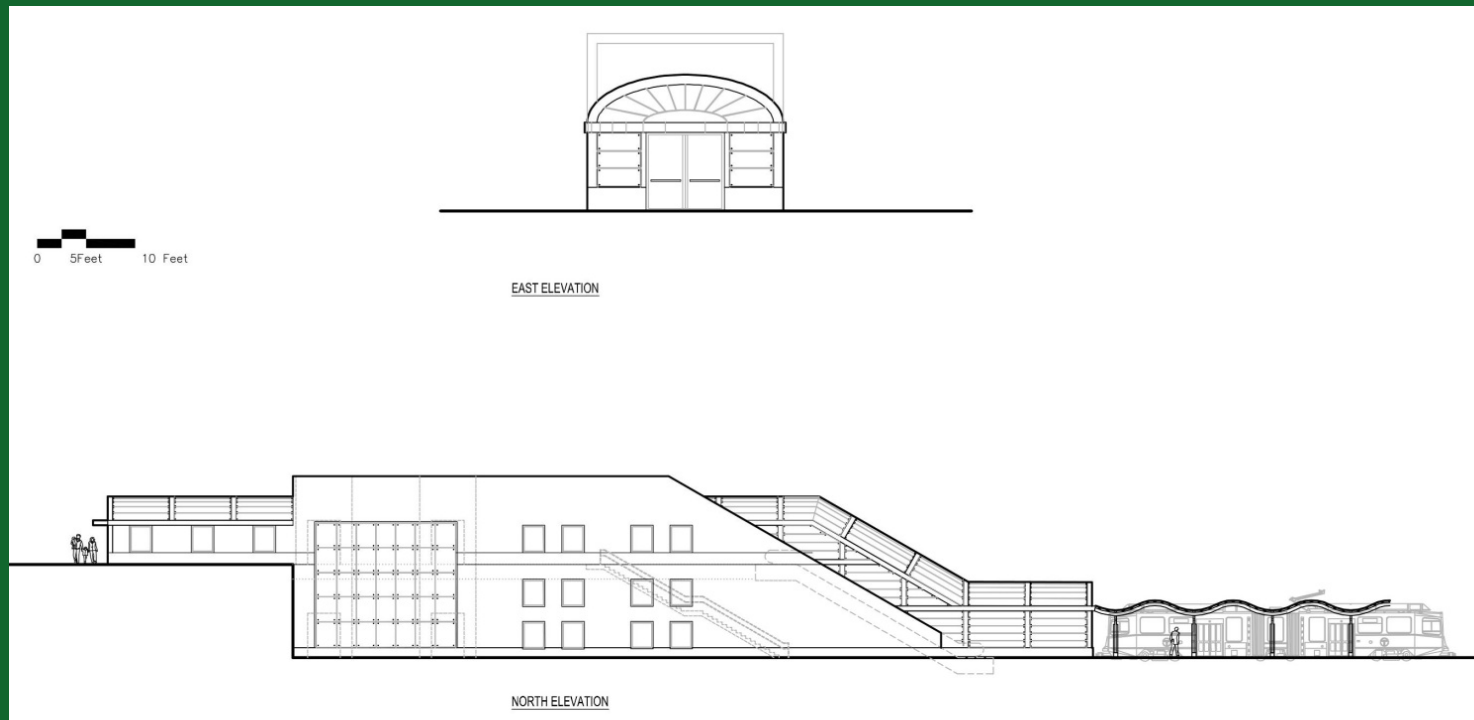

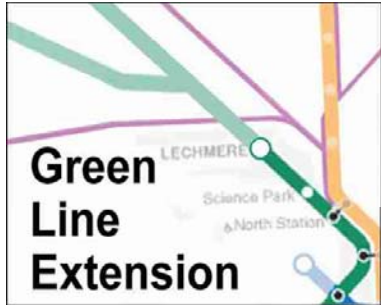

Ridership



- Station Level Boardings

Station	Daily Boardings (2030)
Lechmere	11,100
Brickbottom	2,840
Gilman Square	4,520
Lowell Street	1,260
Ball Square	1,890
College Avenue	2,100
Mystic Valley Parkway/Route 16	2,000
Union Square	2,310

- New MBTA Systemwide Transit Trips: 8,600



Support Facility



- Provides vehicle maintenance & storage on North Side to support extension and reliable service
- Yard 8 in Somerville
 - Best size, location and layout
 - EOT working with Somerville on potential development opportunities

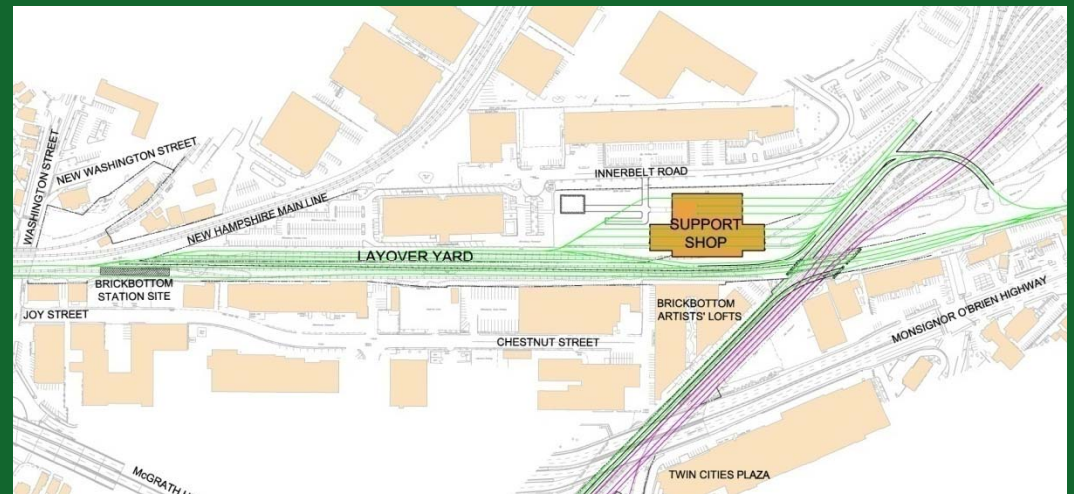



Civic Engagement



- Extensive public process
 - More than 100 meetings with the Project Advisory Group, public agencies, municipal and elected officials, disability commissions, station abutters, neighborhood, advocacy & business briefings
- Website: www.mass.gov/greenlineextension
- Production of detailed reports on key topics



Next Steps



- FTA completes Technical Assistance
- DEIR/EA to be submitted in Spring 2009
- Public Hearing and Comment Period on DEIR/EA
- Preliminary Engineering Summer 2009



Green Line Extension Project



Discussion

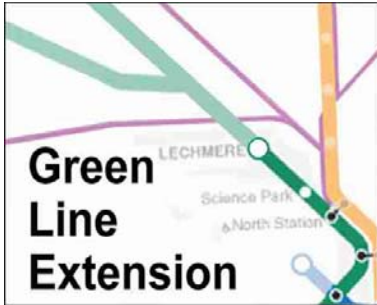

Discussion Guidelines

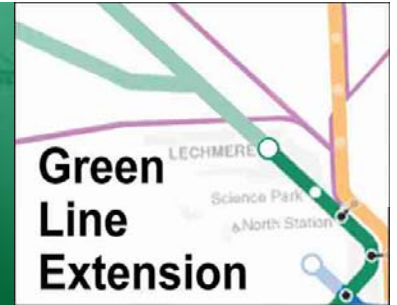

- Respect all speakers
- Comments limited to 2 minutes
- Speakers can make more comments after everyone has made one comment
- Moderator will enforce the guidelines
- Thanks for your cooperation, patience and comments